

# POWERTRUSS COLUMN - LATERAL BRACING & LOAD BEARING FRAME INSTALLATION

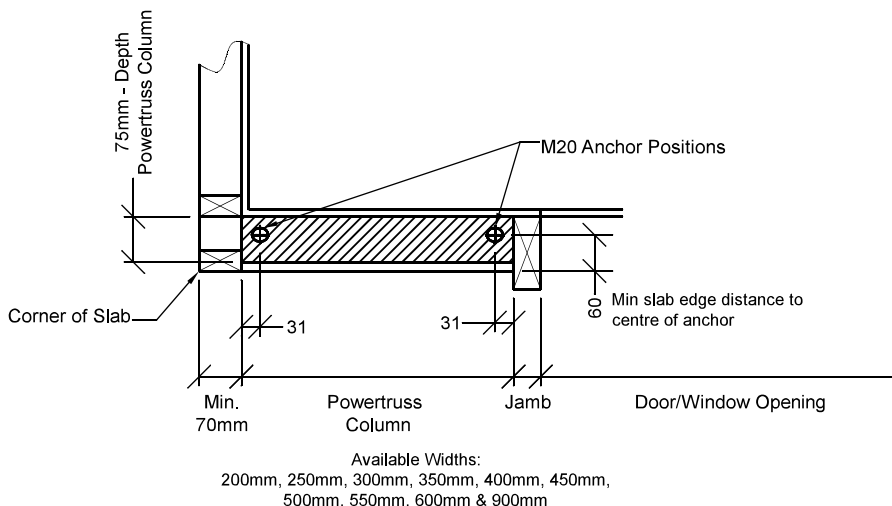

Minimum allowable distance = 70mm from corner of slab to start of Powertruss Frame

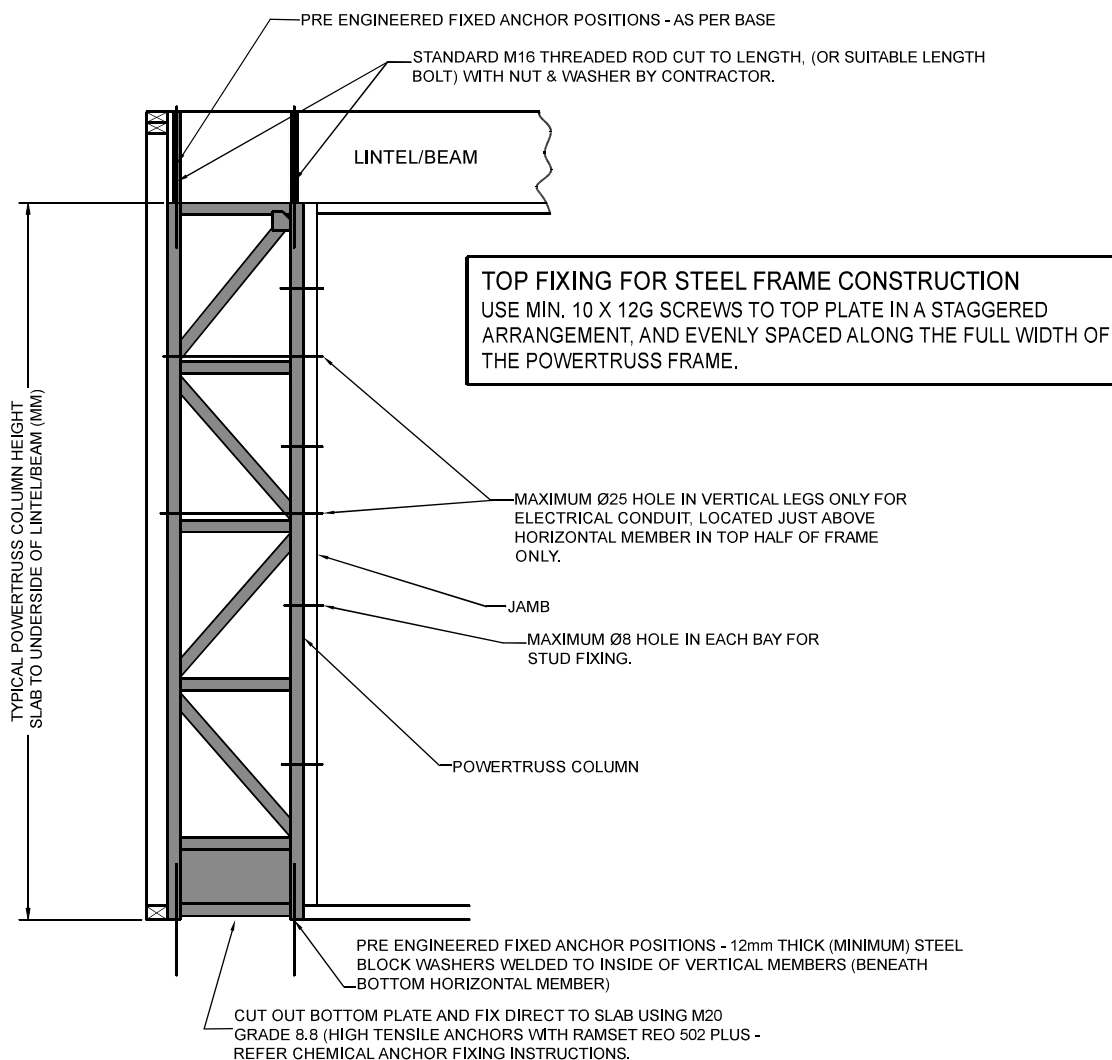

PLEASE ADVISE FINISHED HEIGHT AND WIDTH FOR EACH COLUMN REQUIRED

## POWERTRUSS WALL BRACING SYSTEM

### Queensland (Head Office)

175 Railway Pde  
THORNESIDE, QLD. 4158  
Phone: (07) 3245 4930  
email: [chris@powertruss.com.au](mailto:chris@powertruss.com.au)

### New South Wales

2/62 Belmore Road  
RIVERWOOD, NSW 2210  
Phone: 0410 783 191  
Email: [nsw@powertruss.com.au](mailto:nsw@powertruss.com.au)

### Victoria

16 Gaine Road  
DANDENONG SOUTH, VIC. 3175  
Phone: (03) 9799 9122  
Email: [alex@powertruss.com.au](mailto:alex@powertruss.com.au)